

**Product Name // Stainless Steel Vandal Resistant
Illuminated IP66 Push Button Switch MPI002 Series 12V Red
LED Ring Screw Termination**

[View Product Page](#)

Image not found or type unknown

// Product Description:

- ⊕ Stainless Steel Illuminated Vandal Resistant Push Button Switches
- ⊕ 22mm diameter
- ⊕ Single Contact, push to make, tactile (momentary action)
- ⊕ Choice of Termination, depending on part code:
- ⊕ /28 - 2.8mm Tab
- ⊕ /TE or /TERM - Screw Terminal
- ⊕ /RP - Solder Tag
- ⊕ /FL - 300mm Flying Leads; white - switch, red - LED +, black - LED -
- ⊕ Choice of Illumination style depending on part code:
- ⊕ Part codes prefixed MPI001 - Centre dot
- ⊕ Part codes prefixed MPI002 - Ring
- ⊕ Choice of LED colour depending on part code:
- ⊕ Single colour: /RD - Red, /GN - Green, /AM - Amber, /BL - Blue, /WH - White
- ⊕ Dual colour (only available in /28 2.8mm Tab and /TE Screw Terminal versions): /D1 - Red/Green, /D4 - Red/Blue, /D5 - Green/Blue
- ⊕ (When dual colour LEDs are forward biased the first colour is lit, when reverse biased the second colour is lit)
- ⊕ Choice of LED operating voltage depending on part code suffix:
- ⊕ Resistor installed for operation at a single fixed voltage: /6 - 6V DC, /12 - 12V DC, /24 - 24V DC
- ⊕ Also available with no resistor installed (no suffix) - see data for ratings to enable calculation of suitable series resistor value for application
- ⊕ Front panel seal to IP66 (microswitch not sealed). /RP Solder Tag versions are also rear panel sealed to IP66

// General Information:

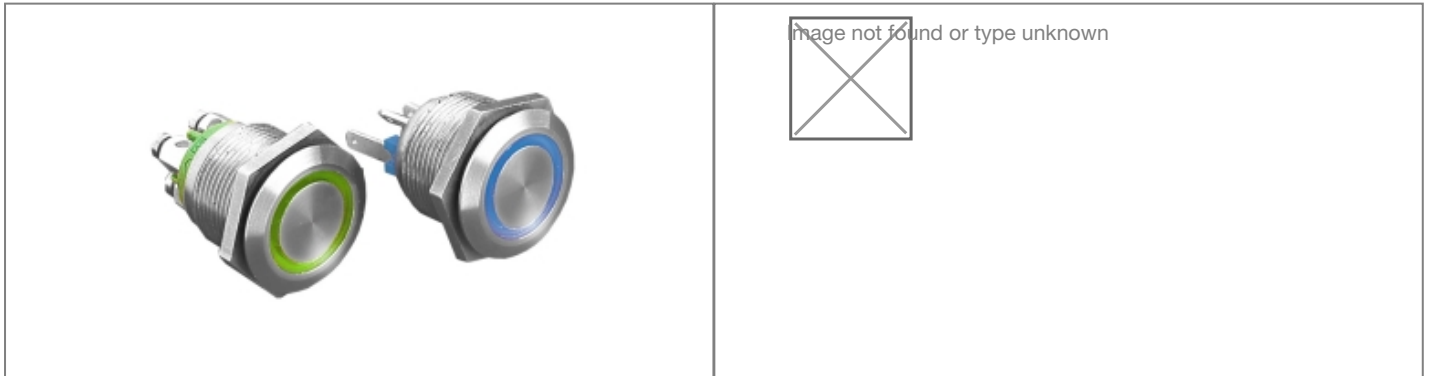
Product Display Title:	Stainless Steel Illuminated Vandal Resistant Push Button Switches
Product Family:	Switches
Product Series:	Push Button
Body Material:	SS 304
Current Max:	0.05A
Diameter:	22mm
Function:	Momentary Action
Illumination Colour:	Red
Illumination Shape:	Ring
Illumination Style:	Illuminated
Illumination Voltage:	12V
Ip Rating:	IP66
Max Operating Temperature:	+70°C
Min Operating Temperature:	-30°C
Thread Size:	0.747 inch x 26TPI
Voltage Max:	24V

// Product PDF Links
[Vandal Resistant switches product...](#)
// Product 3D CAD Model Links
[MPI002/TE/RD/123D CAD Model](#)